

Plug-in adapter for tension spring terminal block ZRK in spacing 5,08 mm and for pressure spring terminal block FRK in spacing 5,08 mm

CONTA-CON in combination with CONTA-CONNECT

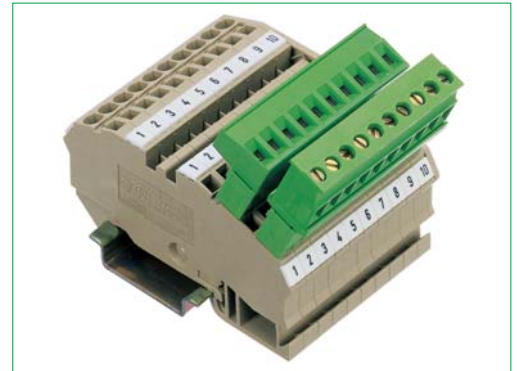

ZRK 2,5/2A in combination within STL 950/10/5,08-G-L



ZRK 2,5/3A in combination within STL 950/10/5,08-G-L

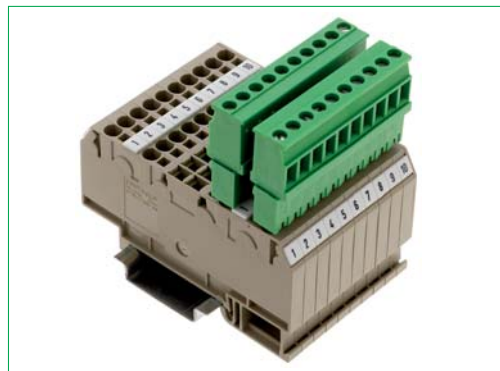

FRK 2,5/4A in combination within STL 950/10/5,08-V-G-L (FRK)



FRKD 2,5 in combination within STL 950/10/5,08-V-G-L (FRK)



ZSRK 2,5/2A in combination within STL 950/10/5,08-G-L



ZSRK 2,5/3A with accentuating tool BW 10

Standard tension spring terminals **ZSRK 2,5**; **ZRK 2,5** and **ZRKD 2,5** from the **CONTA-CONNECT** range can be plugged in at a later stage by using headers **STL 950/... /5,08-G-L**. It is the same with standard pressure spring terminals **FRK 2,5** and **FRKD 2,5** in combination within **STL 950/... /5,08-V-G-L (FRK)**.

Headers are designed for fast, easy and safe connection of the different levels.

Accentuating tools **BW** (1-10 poles available) serve to open up to 10 springs at a time. This is how to facilitate and speed up installation.

ZRK | FRK spring technology along with **CONTA-CON** printed circuit board plug-in connectors enable you to tremendously reduce high-cost final assembly time and to assure speedy parts replacement during service and maintenance. All combinations allow for coding without loss of poles (cf. page 124, Coding).

Note: Plug-in connectors may not be connected or disconnected with a voltage exceeding 42 V. When using tension spring terminals with headers **STL 950/... /5,08-G-L** on the distributing side, the rated voltage must not exceed 50 V because live headers are not touch-proof under unprotected conditions.

Plug-in adapter for tension spring terminal block in spacing 5,08

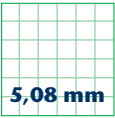

5,08 mm

STL 950/... /5,08-G-L (ZRK)

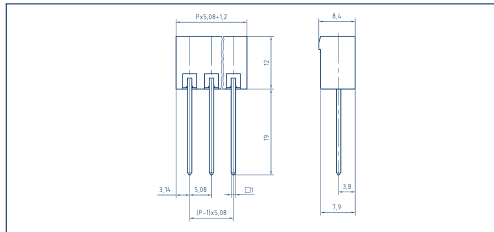

STL 950/... /5,08-V-G-L (FRK)

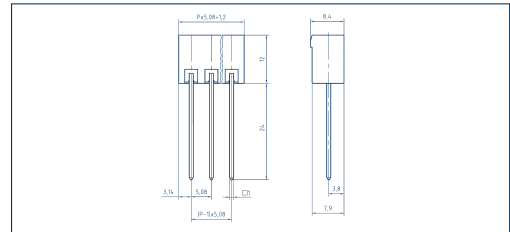

Drawings

Dimensions

Insulation mm	5,08
Insulation stripping length mm	—
PCB hole diameter mm	—
Dimensions (L x B x H)	—

Cross sections

single wire (solid) mm ²	—
stranded wire (flexible) mm ²	—
stranded wire (with ferrules) mm ²	—

Output information

Rated voltage V	300 V	250 V
Rated current A	15 A	12 A (T60)
Cross section max. AWG/mm ²	—	—
Rating impulse voltage	—	4,00 kV
Rated torque/Screw size	—	—
Dirt level	—	3

Materials

Insulating material/Flammability class	PA 6.6 V0 / UL 94 V0
Temperature Range	-30°C / +105°C
Clamping part	—
Clamping cage/Eccentric	—
Contact pin	Cu
Cage tension spring	—
Wire protection	—
Soldering lug	—
Contact Spring	—

Order information

No. of poles	Cat.-No.	Qty.p.pck.	No. of poles	Cat.-No.	Qty.p.pck.
	●			●	
	green			green	
	(Ral 6018)			(Ral 6018)	
1	—	50	1	—	50
2	13154.1	50	2	13871.1	50
3	13155.1	50	3	13872.1	50
4	13156.1	50	4	13873.1	50
5	13157.1	50	5	13874.1	50
6	13158.1	50	6	13875.1	50
7	13159.1	50	7	13876.1	50
8	13160.1	50	8	13877.1	50
9	13161.1	50	9	13878.1	50
10	13162.1	50	10	13879.1	50

Accessories

Accentuating tool BW 1...10	for ZRK	●	for FRK
		black	
		(Ral 9011)	
1	3778.0	1	1
2	3779.0	1	2
3	3780.0	1	3
4	3781.0	1	4
5	3782.0	1	5
6	3802.0	1	6
7	3803.0	1	7
8	3804.0	1	8
9	3805.0	1	9
10	3806.0	1	10

Coding	Page 124 - 125	Page 124 - 125
--------	----------------	----------------

P.C. BOARD PLUG-IN CONNECTORS

Plug-in adapter for tension spring terminal block in spacing 5,08

Connector for:
STL 950/... /5,08-G-L

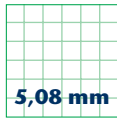

5,08 mm

Drawings

PKB 950/... /5,08

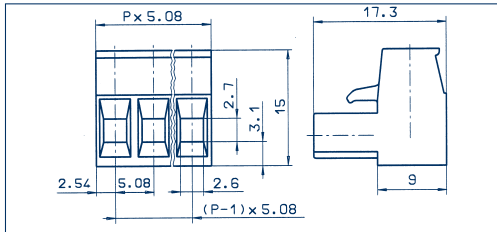
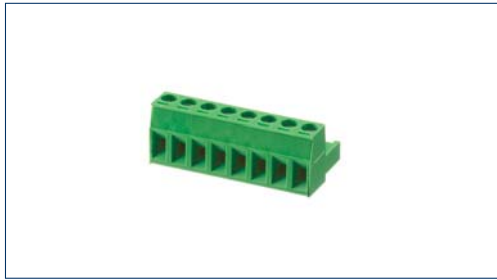

PKB 1100/... /5,08

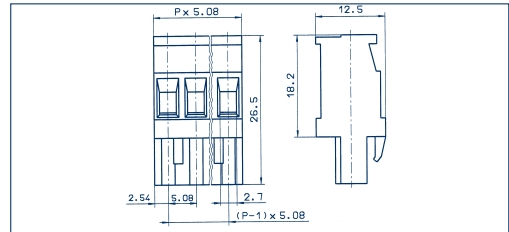

Connection principle

Dimensions

Spacing mm
Insulation stripping length mm
PCB hole diameter mm

Connection data

Single wire (solid) mm²
Stranded wire (flexible) mm²
Stranded wire (with ferrules) mm²

Rating

Rated voltage V
Rated current A
Cross section max. AWG/mm²
Rated surge voltage
Rated torque/Screw size
Contamination degree

Materials

Insulating material/Flammability class
Temperature Range
Clamping part
Clamping cage/Eccentric
Contact pin
Cage tension spring
Wire protection
Soldering lug
Contact Spring

Order information

Standard colour(s)
(further colours on request, see page 5)

Strain-relief-clamp

5,08

6,00

-

2,50

2,50

2,50



300 V

15 A

22-12

-

-

-



250 V

12 A (T60)

2,50

4,00 kV

0,50 Nm/M3

3

PA 6.6 V0 / UL 94 V0

-30°C / +105°C

CuZn

-

-

-

-

-

CuSn

No. of poles

Cat.-No.

Qty.p.pck.



green

(Ral 6018)

2

3

4

5

6

7

8

9

10

11230.1

11231.1

11232.1

11233.1

11234.1

11235.1

11236.1

11237.1

11238.1

50

50

50

50

50

50

50

50

50

Strain-relief-clamp

5,08

7,00

-

2,50

2,50

2,50



300 V

15 A

22-10

-

-

-



250 V

12 A (T60)

2,50

4,00 kV

0,50 Nm/M3

3

PA 6.6 V0 / UL 94 V0

-30°C / +105°C

CuZn

-

-

-

-

CuSn

No. of poles

Cat.-No.

Qty.p.pck.



green

(Ral 6018)

2

3

4

5

6

7

8

9

10

11305.1

11306.1

11307.1

11308.1

11309.1

11310.1

11311.1

11312.1

11313.1

50

50

50

50

50

50

50

50

50

Accessories

Marking
Coding

Page 124 - 127
Page 122 - 123

Page 124 - 127
Page 122 - 123

Plug-in adapter for tension spring terminal block in spacing 5,08

Connector for:
STL 950/... /5,08-G-L

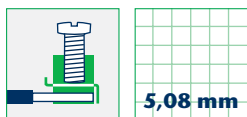

PKB 1110/... /5,08

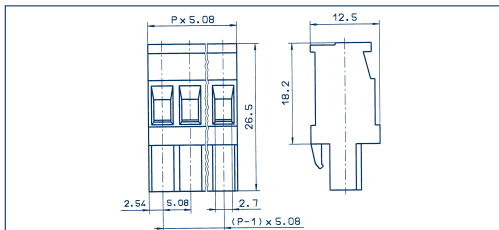

Drawings

Connection principle

Dimensions

Spacing mm
Insulation stripping length mm
PCB hole diameter mm

Connection data

Single wire (solid) mm²
Stranded wire (flexible) mm²
Stranded wire (with ferrules) mm²

Rating

Rated voltage V
Rated current A
Cross section max. AWG/mm²
Rated surge voltage
Rated torque/Screw size
Contamination degree

Materials

Insulating material/Flammability class
Temperature Range
Clamping part
Clamping cage/Eccentric
Contact pin
Cage tension spring
Wire protection
Soldering lug
Contact Spring

Order information

Standard colour(s)
(further colours on request, see page 5)

Strain-relief-clamp

5,08

7,00

–

2,50

2,50

2,50



300 V

15 A

22-10

–

–

–



250 V

12 A (T60)

2,50

4,00 kV

0,50 Nm/M3

3

PA 6.6 V0 / UL 94 V0

-30°C / +105°C

CuZn

–

–

–

–

–

CuSn

No. of poles	Cat.-No.	Qty.p.pck.
	●	
	green	
	(Ral 6018)	
2	11339.1	50
3	11340.1	50
4	11341.1	50
5	11342.1	50
6	11343.1	50
7	11344.1	50
8	11345.1	50
9	11346.1	50
10	11347.1	50

Accessories

Marking Page 124 - 127
Coding Page 122 - 123