

Screw-Wire Protector Clamp Connection Panel Mount Conta-Strips™



Developed for quick and efficient wire-to-wire connections in lighting, appliances, HVAC and industrial equipment/devices where low cost, wire terminations are needed. Conta-Strips™ are modern replacements for traditional Double Row Barrier Style Terminal Blocks. Unlike Barrier Blocks, they feature a touch-proof design with totally recessed metal parts which eliminate any chance of accidental shorts and minimize the possibility of electrical shock. Easy to use, Conta-Strips™ are supplied with open clamps ready for immediate wire hookup. Simply, strip the wire, insert and tighten the screw for a reliable electrical connection. Conta-Strips™ eliminate the need for costly and labor intensive wire preparations associated with the use of spade or ring lugs. Conta-Strips™ are available in 12 Pole Strips which can be readily cut to any pole position using a saw or a utility knife. Or, they can be ordered pre-cut to the required number of poles. Use versions with standoff feet for Industrial Control Equipment Applications such as motor control where maximum creepage and clearance distance is a design consideration.

Feed-Through Standoff Feet

- Side Wire Entry
- Housing: Polyamide 6.6
- Wire Protector/Center Barrier: Stainless Steel
- Insert: Nickel Plated Copper Alloy
- Screw: Zinc-Yellow Chromate Plated Steel
- Color: White, Translucent
- Imprinting Available

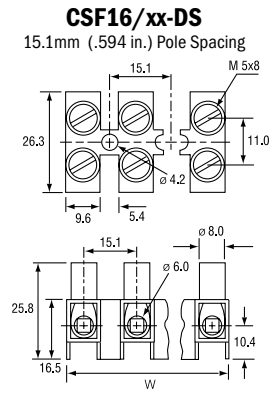
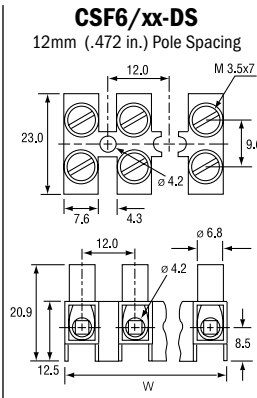
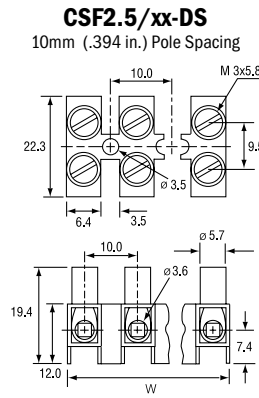
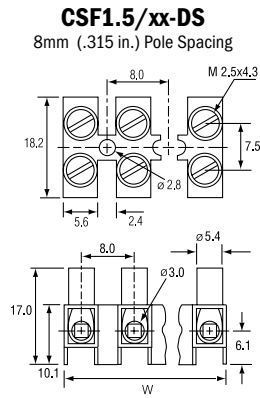

Ordering Information: xx= No. of Poles	CSF1.5/xx-DS			CSF2.5/xx-DS			CSF6/xx-DS			CSF16/xx-DS		
	Cat. No.	Width - W mm (in.)	Std. Pack	Cat. No.	Width - W mm (in.)	Std. Pack	Cat. No.	Width - W mm (in.)	Std. Pack	Cat. No.	Width - W mm (in.)	Std. Pack
2	27025.3	13.6 (.54)	100	27121.3	17.0 (.67)	100	27217.3	20.0 (.79)	100	27289.3	25.0 (.98)	50
3	27026.3	21.5 (.85)	100	27122.3	27.0 (1.06)	100	27218.3	32.0 (1.26)	100	27290.3	40.0 (1.58)	50
4	27027.3	29.5 (1.16)	100	27123.3	37.0 (1.46)	100	27219.3	44.0 (1.73)	100	27291.3	55.0 (2.17)	50
5	27028.3	37.4 (1.47)	100	27124.3	47.0 (1.85)	100	27220.3	56.0 (2.21)	100	27292.3	70.0 (2.76)	50
6	27029.3	45.4 (1.79)	50	27125.3	57.0 (2.24)	50	27221.3	68.0 (2.68)	50	27293.3	86.0 (3.39)	25
7	27030.3	53.3 (2.10)	50	27126.3	67.0 (2.64)	50	27222.3	80.0 (3.15)	50	27294.3	101.0 (3.98)	25
8	27031.3	61.3 (2.41)	50	27127.3	77.0 (3.03)	50	27223.3	92.0 (3.62)	50	27295.3	116.0 (4.57)	25
9	27032.3	69.2 (2.72)	50	27128.3	87.0 (3.43)	50	27224.3	104.0 (4.10)	50	27296.3	131.0 (5.16)	25
10	27033.3	77.2 (3.04)	50	27129.3	97.0 (3.82)	50	27225.3	116.0 (4.57)	25	27297.3	146.0 (5.75)	10
11	27034.3	85.1 (3.35)	50	27130.3	107.0 (4.21)	50	27226.3	128.0 (5.04)	25	27298.3	161.0 (6.34)	10
12	27035.3	93.0 (3.66)	50	27131.3	117.0 (4.61)	50	27227.3	140.0 (5.51)	25	27299.3	176.0 (6.93)	10

Electrical Ratings:	CSF1.5/xx-DS		CSF2.5/xx-DS		CSF6/xx-DS		CSF16/xx-DS	
IEC 947-7-1	400V / 18A / 1.5mm ²		400V / 26A / 4mm ²		400V / 44A / 6mm ²		800V / 82A / 16mm ²	
CSA LR 703305	300V / 15A / 22-16 AWG		600V / 30A / 18-12 AWG		600V / 40A / 18-10 AWG		600V / 65A / 18-6 AWG	
E196136	600V / 20A / 22-12 AWG		600V / 30A / 22-10 AWG		600V / 40A / 20-8AWG		600V / 63A / 14-6 AWG	
Insulation Stripping Length mm (in.)	5 (.20)		6 (.24)		7 (.28)		8 (.32)	
Tightening Torque Nm (lbf.-in.)	.75 (6.5)		.85 (7.5)		.85 (7.5)		2.4 (21.0)	
Screw Hole Diameter mm (in.)	3.0 (.12)		3.5 (.14)		4.0 (.16)		5.5 (.22)	
Mounting Hole Diameter mm (in.)	2.8 (.110)		3.5 (.138)		4.2 (.165)		4.2 (.165)	
Accessories:								
External Insulated Jumpers:*								
2 Pole	Cat.No. 27435.4	Std.Pack 50	Cat.No. 27447.4	Std.Pack 50	Cat.No. 27459.4	Std.Pack 50	Cat.No. 27471.4	Std.Pack 20
3 Pole	Cat.No. 27436.4	Std.Pack 50	Cat.No. 27448.4	Std.Pack 50	Cat.No. 27460.4	Std.Pack 50	Cat.No. 27472.4	Std.Pack 20
4 Pole	Cat.No. 27437.4	Std.Pack 50	Cat.No. 27449.4	Std.Pack 50	Cat.No. 27461.4	Std.Pack 50	Cat.No. 27473.4	Std.Pack 20
12 Pole [†]	Cat.No. 27445.4	Std.Pack 10	Cat.No. 27457.4	Std.Pack 10	Cat.No. 27469.4	Std.Pack 10	Cat.No. 27481.4	Std.Pack 5
Marking Plates:								
Blank			Cat.No. 27495.7	Std.Pack 25	Cat.No. 27496.7	Std.Pack 25	Cat.No. 27497.7	Std.Pack 25
Numbered 1 - 12			Cat.No. 27498.7	Std.Pack 25	Cat.No. 27500.7	Std.Pack 25	Cat.No. 27502.7	Std.Pack 25
Numbered 13 - 24			Cat.No. 27499.7	Std.Pack 25	Cat.No. 27501.7	Std.Pack 25	Cat.No. 27503.7	Std.Pack 25
Isolation Partition:			Cat.No. 27487.4	Std.Pack 10	Cat.No. 27487.4	Std.Pack 10		
Mounting Pins:			Cat.No. 27490.4	Std.Pack 100	Cat.No. 27490.4	Std.Pack 100	Cat.No. 27491.4	Std.Pack 100

* For Electrical Ratings see corresponding Conta-Strips
[†] Other Pole Positions available, contact Conta-Clip, Inc.

Note: Dimensions on Diagrams are shown in mm. Metric Conversion: in. = mm x 0.03937

